

Type 546 Vented Ball Valve

Standard Features

- **Size**
3/8"-4"
- **Material**
PVC, CPVC
- **Available**
Socket
Threaded
Flanged
Spigot (PVDF and PP only)
- **Seat**
PTFE
- **Seals**
EPDM or FPM
- **Mounting**
Stainless steel threaded inserts
for easy and secure mounting

Optional Features

- **Actuation**
Electric actuation
Pneumatic actuation
- **Limit Switches**
Available for both manual and
actuated versions
- **Handles**
Lockable handle
Handle extension

Standards

- **NSF61**
Pending 2½", 3", 4"
- **ISO9393**



General

Based on Georg Fischer's premium ball valve series, the vented ball valve is designed for applications such as chlorinated water, water where bleach (sodium hypochlorite solutions) is present, and other applications where liquids requiring out-gassing exist.* The special vent on one side of the ball allows for pressure to be released back into the closed system. This helps prevent potentially dangerous pressure from building up inside the valve. Since the valve is based on the type 546 series, virtually all of the same accessories are available.

*Chemical applications vary from system to system. Issues such as concentration, temperature, and pressure all play a role. It is the responsibility of the individual user to verify compatibility and recommend every application be verified and tested by internal experts or a third party.

Ideal for Virtually any application

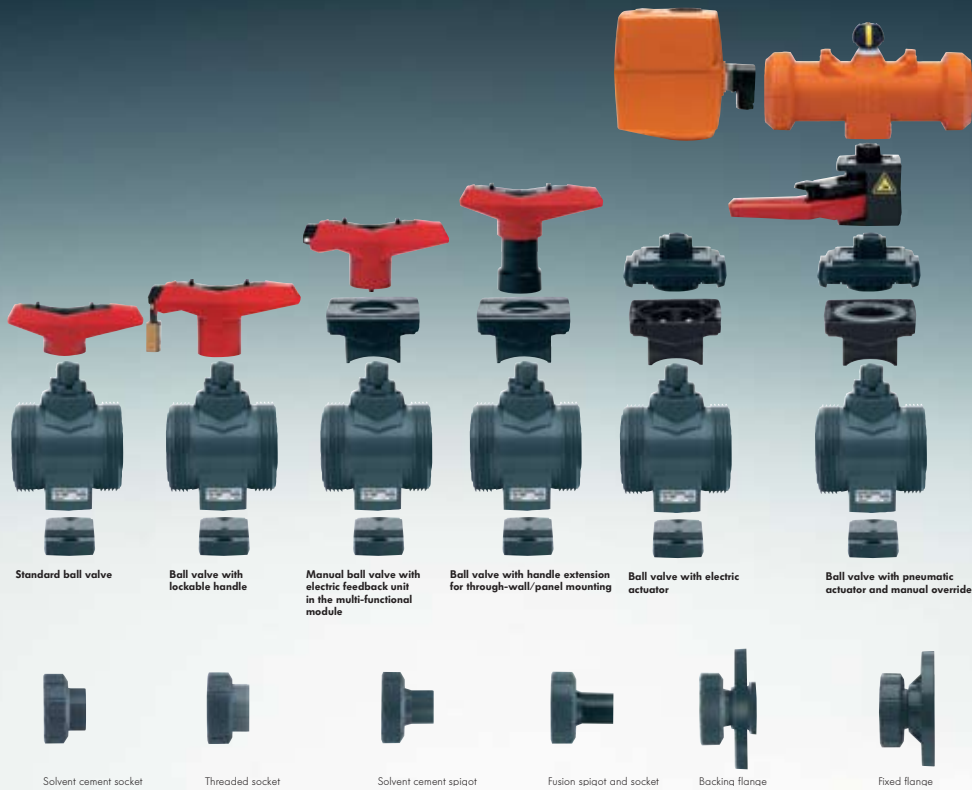

Technical Data

Pressure-Temperature Diagrams Technical data for Type 546 Vented Ball Valve 3/8"-4"

The following pressure temperature diagrams are based on a lifetime of 25 years and the medium water or similar media

PVC

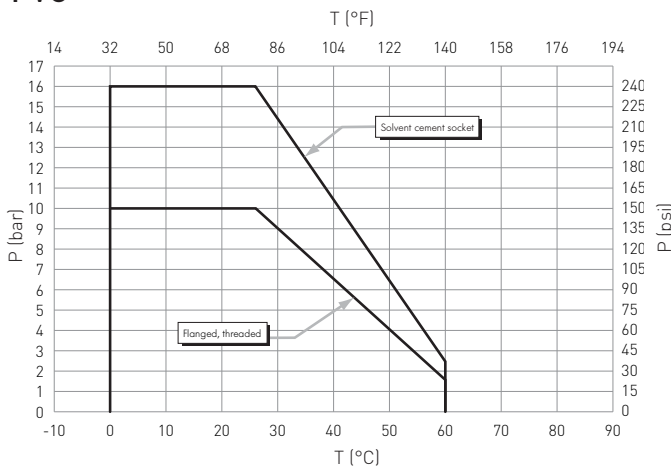

CPVC

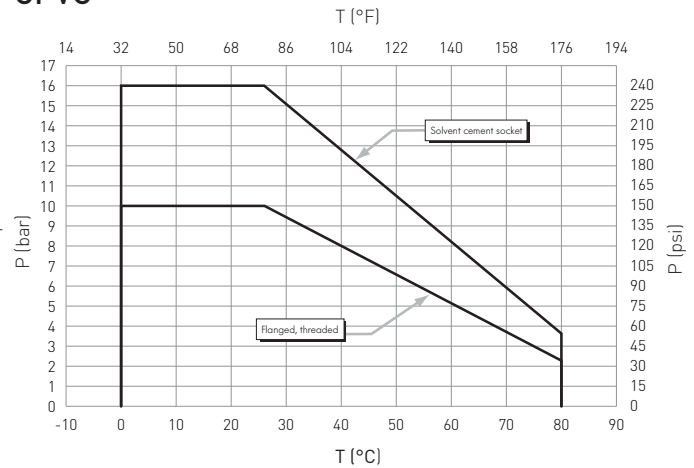



Type 546 True Union Vented Ball Valve-PVC

Solvent Cement Socket/Threaded NPT

Size ID Inch	EPDM Seals		FPM Seals	
3/8	V161 546 341		V161 546 351	
1/2	V161 546 342		V161 546 352	
3/4	V161 546 343		V161 546 353	
1	V161 546 344		V161 546 354	
1 1/4	V161 546 345		V161 546 355	
1 1/2	V161 546 346		V161 546 356	
2	V161 546 347		V161 546 357	
2 1/2	V161 546 348		V161 546 358	
3	V161 546 349		V161 546 359	
4	V161 546 350		V161 546 360	

Note: 2 1/2", 3", and 4" have socket ends only. See table below for larger NPT.



Type 546 True Union Vented Ball Valve-CPVC

Solvent Cement Socket/Threaded NPT

Size	EPDM Seals		FPM Seals	
3/8	V163 546 341		V163 546 351	
1/2	V163 546 342		V163 546 352	
3/4	V163 546 343		V163 546 353	
1	V163 546 344		V163 546 354	
1 1/4	V163 546 345		V163 546 355	
1 1/2	V163 546 346		V163 546 356	
2	V163 546 347		V163 546 357	
2 1/2	V163 546 348		V163 546 358	
3	V163 546 349		V163 546 359	
4	V163 546 350		V163 546 360	

Note: 2 1/2", 3", and 4" have socket ends only; NPT available upon request

^ = 40% Restock Charge

* = Non-Cancelable
Non-Returnable

PVC/CPVC

With mounting inserts • With solvent cement sockets inch ASTM

• Inclusive 2 threaded valve ends NPT

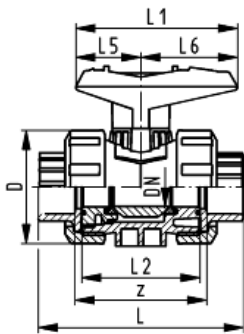

Inch	psi		Cv-value [gal/min]	D [mm]	H [mm]	H1 [mm]	H2 [mm]	L [mm]		L1 [mm]	L2 [mm]
	Socket	NPT						Socket	NPT		
3/8	232	150	4.9	50	57	27	12	105	98	77	56
1/2	232	150	12.9	50	57	27	12	105	98	77	56
3/4	232	150	24.5	58	67	30	12	121	111	97	65
1	232	150	49.0	68	73	36	12	133	127	97	71
1 1/4	232	150	70.0	84	90	44	15	154	147	128	85
1 1/2	232	150	112.0	97	97	51	15	164	157	128	89
2	232	150	217.1	124	116	64	15	183	183	152	101
2 1/2	232	150	350.0	166	149	85	15	233	234	270	136
3	232	150	490.0	200	161	105	15	254	255	270	141
4	232	150	770.0	238	178	123	22	301	302	320	164

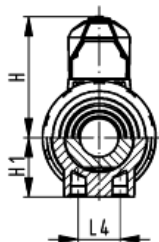

L4 [mm]	L5 [mm]	L6 [mm]	M	Z [mm]
25	32	45	M6	67
25	32	45	M6	61
25	39	58	M6	70
25	39	58	M6	76
45	54	74	M8	90
45	54	74	M8	94
45	66	87	M8	107
70	64	206	M8	144
70	64	206	M8	151
120	64	256	M12	174

GF Piping Systems → worldwide at home

Our sales companies and representatives ensure local customer support in over 100 countries.

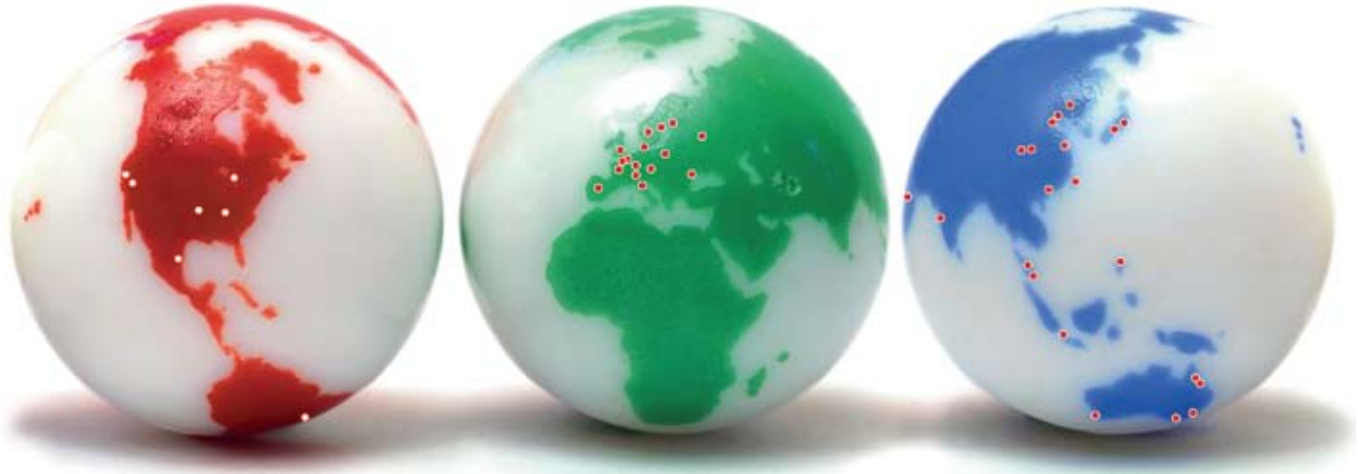

GF Piping Systems

2882 Dow Avenue, Tustin, CA 92780-7258

Tel. (714) 731-8800, Toll Free (800) 854-4090, Fax (714) 731-6201

e-mail: us.ps@georgfischer.com

www.gfpiping.com

Australia

Georg Fischer Pty Ltd
Riverwood NSW 2210 Australia
Phone +61(0)2 9502 8000
australia.ps@georgfischer.com
www.georgfischer.com.au

Austria

Georg Fischer
Rohrleitungssysteme GmbH
3130 Herzogenburg
Phone +43(0)2782 856 43-0
austria.ps@georgfischer.com
www.georgfischer.at

Belgium / Luxembourg

Georg Fischer NV/SA
1070 Bruxelles/Brüssel
Phone +32(0)2 556 40 20
be.ps@georgfischer.com
www.georgfischer.be

Brazil

Georg Fischer Ltda
04795-100 São Paulo
Phone +55(0)11 5687 1311
br.ps@georgfischer.com

Canada

Georg Fischer Piping Systems Ltd
Brampton, ON L6T 4E3
Phone +(905) 792-8005
ca.ps@georgfischer.com
www.gfpiping.ca

China

Georg Fischer
Piping Systems Ltd Shanghai
Pudong, Shanghai 201319
Phone +86(0)21 58 13 33 33
china.ps@georgfischer.com
www.cn.piping.georgfischer.com

Denmark / Iceland

Georg Fischer A/S
2630 Taastrup
Phone +45 (0)70 22 19 75
info.dk.ps@georgfischer.com
www.georgfischer.dk

France

Georg Fischer SAS
95932 Roissy Charles de Gaulle Cedex
Phone +49(0)7161 302-0
fr.ps@georgfischer.com
www.georgfischer.fr

Germany

Georg Fischer GmbH
73095 Albershausen
Phone +49(0)7161 302-0
info.de.ps@georgfischer.com
www.georgfischer.de

India

Georg Fischer Piping Systems Ltd
400 076 Mumbai
Phone +91 224007 2001
in.ps@georgfischer.com
www.georgfischer.in

Italy

Georg Fischer S.p.A.
20063 Cernusco S/N (MI)
Phone +3902 921 861
it.ps@georgfischer.com
www.georgfischer.it

Japan

Georg Fischer Ltd
556-0011 Osaka,
Phone +81(0)6 6635 2691
jp.ps@georgfischer.com
www.georgfischer.jp

Korea

Georg Fischer Piping Systems
Guro-3 dong, Guro-gu, Seoul, Korea
Phone +82(0)2 2081 1450
Fax +82(0)2 2081 1453
kor.ps@georgfischer.com

Malaysia

Georg Fischer (M) Sdn. Bhd.
40460 Shah Alam, Selangor
Phone +60 (0)3 5122 5585
conne.kong@georgfischer.com

Mexico

Georg Fischer S.A. de C.V.
Apodaca, Nuevo Leon
CP66636 Mexico
Phone +52 (81)1340 8586
Fax +52 (81)1522 8906

Middle East

Georg Fischer Piping Systems
Dubai, United Arab Emirates
Phone +971 4 289 49 60
info.export@georgfischer.com
www.export.georgfischer.com

Netherlands

Georg Fischer N.V.
8161 PA Epe
Phone +31(0)578 678 222
nl.ps@georgfischer.com
www.georgfischer.nl

Norway

Georg Fischer AS
1351 Rud
Phone +47(0)67 18 29 00
no.ps@georgfischer.com
www.georgfischer.no

Poland

Georg Fischer Sp. z o.o.
02-226 Warszawa
Phone +48(0)22 313 10 50
poland.ps@georgfischer.com
www.georgfischer.pl

Romania

Georg Fischer
Piping Systems Ltd
020257 Bucharest - Sector 2
Phone +40(0)21 230 53 80
ro.ps@georgfischer.com
www.export.georgfischer.com

Russia

Georg Fischer Piping Systems
Moscow 125047
Tel. +7 495 258 60 80
ru.ps@georgfischer.com
www.georgfischer.ru

Singapore

Georg Fischer Pte Ltd
528 872 Singapore
Phone +65(0)67 47 06 11
sgp.ps@georgfischer.com
www.georgfischer.com.sg

Spain / Portugal

Georg Fischer S.A.
28046 Madrid
Phone +34(0)91 781 98 90
es.ps@georgfischer.com
www.georgfischer.es

Sweden / Finland

Georg Fischer AB
12523 Älvsjö-Stockholm
Phone +46(0)8 506 775 00
info.se.ps@georgfischer.com
www.georgfischer.se

Switzerland

Georg Fischer
Rohrleitungssysteme (Schweiz) AG
8201 Schaffhausen
Phone +41(0)52 631 30 26
ch.ps@georgfischer.com
www.piping.georgfischer.ch

Taiwan

Georg Fischer Piping Systems
San Chung City, Taipei Hsien
Phone +886 2 8512 2822
Fax +886 2 8512 2823

United Kingdom / Ireland

Georg Fischer Sales Limited
Coventry, CV2 2ST
Phone +44(0)2476 535 535
uk.ps@georgfischer.com
www.georgfischer.co.uk

USA / Latin America / Caribbean

Georg Fischer LLC
Tustin, CA 92780-7258
Phone +1(714) 731 88 00
Toll Free 800 854 40 90
us.ps@georgfischer.com
www.us.piping.georgfischer.com